

Galaxy Elevator Interface Events of Operation

(In-cab reader controls call buttons)

Relays interact with the elevator company provided interface cabinet completing the floor call button circuits allowing the cardholder to select any floor he/she has access to, at the same time restricting floor call buttons from being selected for floors with no access.

Call buttons that were selected are recorded in Galaxy activity history by using a elevator company provided relay to activate an input in the Galaxy controller

Card information is transmitted to the Galaxy controller. Access to floors is permitted based on access level for the card presented. A relay per floor will activate

User enters the elevator and presents access card to the reader in the cab

User calls the elevator cab to the floor they are on using elevator call buttons in lobbies on all floors

If floor button history is needed, (2) reports are generated in System Galaxy-Activity History for the in cab reader and for inputs

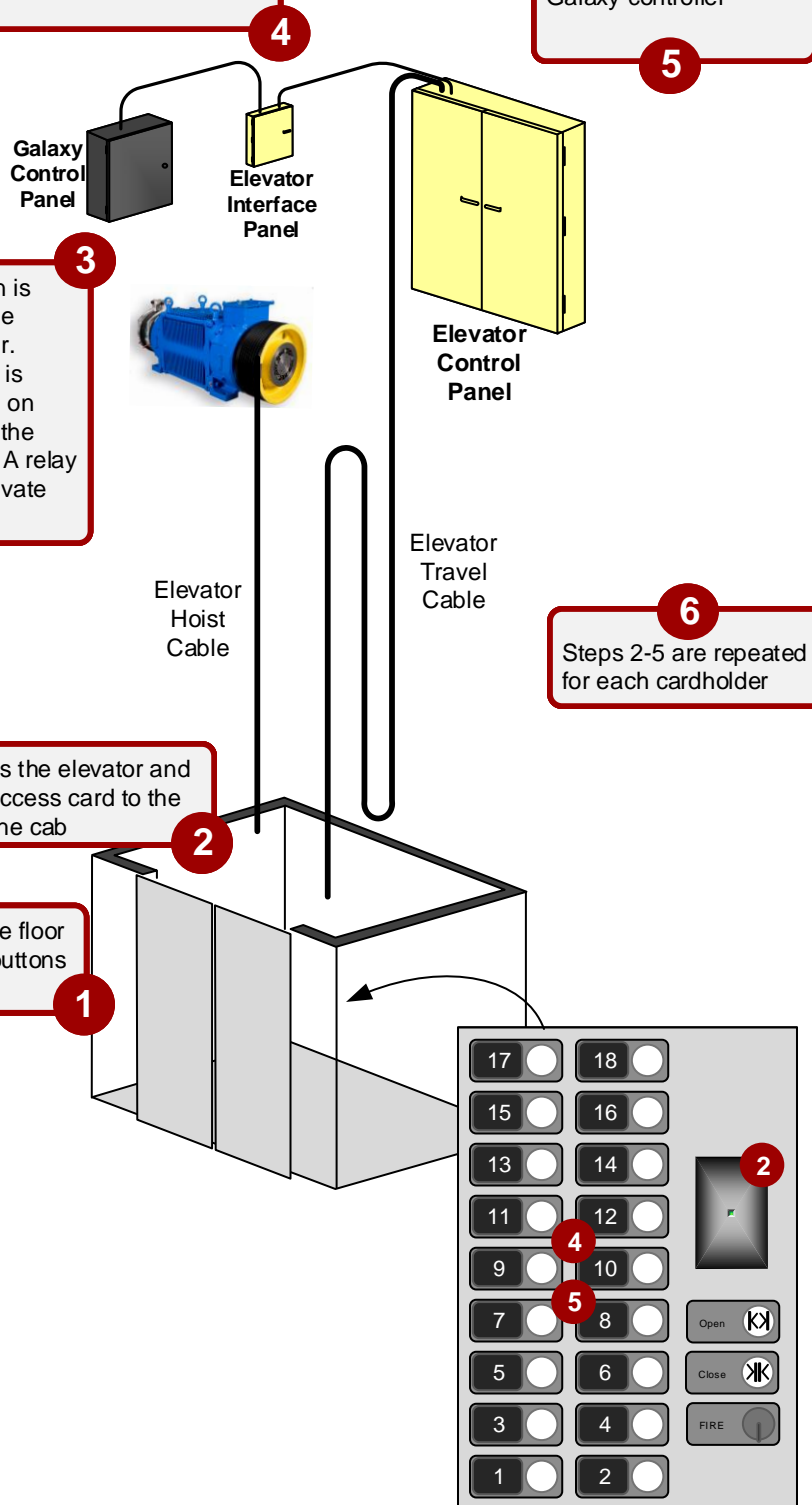

Recommended Components

(per elevator cab)

- Qty (1) Large 2 Dr Controller #**635LG2**
- Qty (1) 635 DSI Dual Serial Interface board #**20-0655-10**
- Qty (x) 635 ERM Elevator Relay Module #**20-0620-00**
(1 ERM for every 8 floors controlled)
- Qty (1) Card Reader #**TBD**
- Qty (x) Stacker Kit #**92-0630-00**
(Allows 2 ERM boards to be stacked in the controller)
- **Additional Power Supply for ERM power**



Additional Power Supply

The ERMs require an additional power supply in case the total # of boards power consumption is greater than the controller power supply. Each ERM draws .60amp with all relays active.

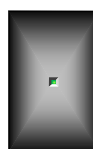

Reader

Cab mounted reader terminates @DRM board. Uses traveler cable conductors OR wireless reader kit to transmit data to controller

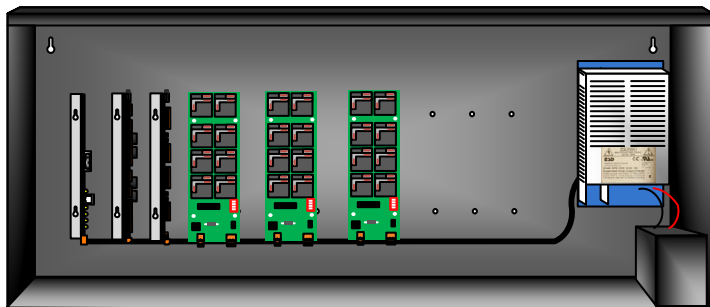

Controller

Single LG controller may accommodate up to (8) ERMs for control of 64 floor call buttons in the cab. Additional ERMs (15 total for 120 floors) may be housed in remote enclosures. The controller also houses the DRM for the cab reader connection and the DSI for the communication to the ERM boards

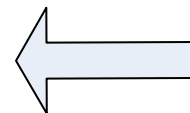
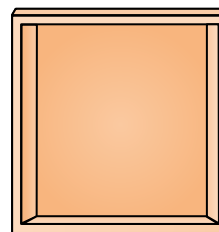

Elevator Interface Panel

Provided by others-This enclosure is usually provided by the elevator equipment provider/installer. It allows connection to the required circuits without having to tamper with the elevator system.